

## Mounting OPS HD to Your Cap

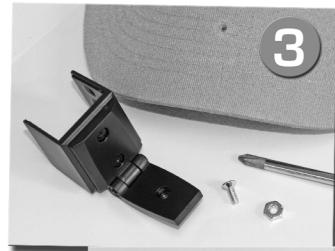
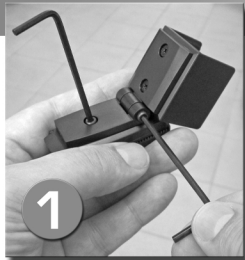

[1] Use hex key to loosen hinge. Pull up the U-shaped camera holder.

[2] Use hex key to remove screw and separate the top part of the mount from the clip.

[3-4] Fasten the camera holder through the bill of the cap using the screw and nut.

[5] Adjust the angle of the camera and tighten the hinge with the hex key. Don't overtighten.

[6] You are ready to shoot. Always use the rubber cover to keep dust off of your OPS HD.